

HIPERFIRE®

RBT®, Semi-Auto

Parts and Installation Manual

Proper installation and use of this product are the responsibility of the purchaser. Consult with HIPERFIRE with any questions or problems.

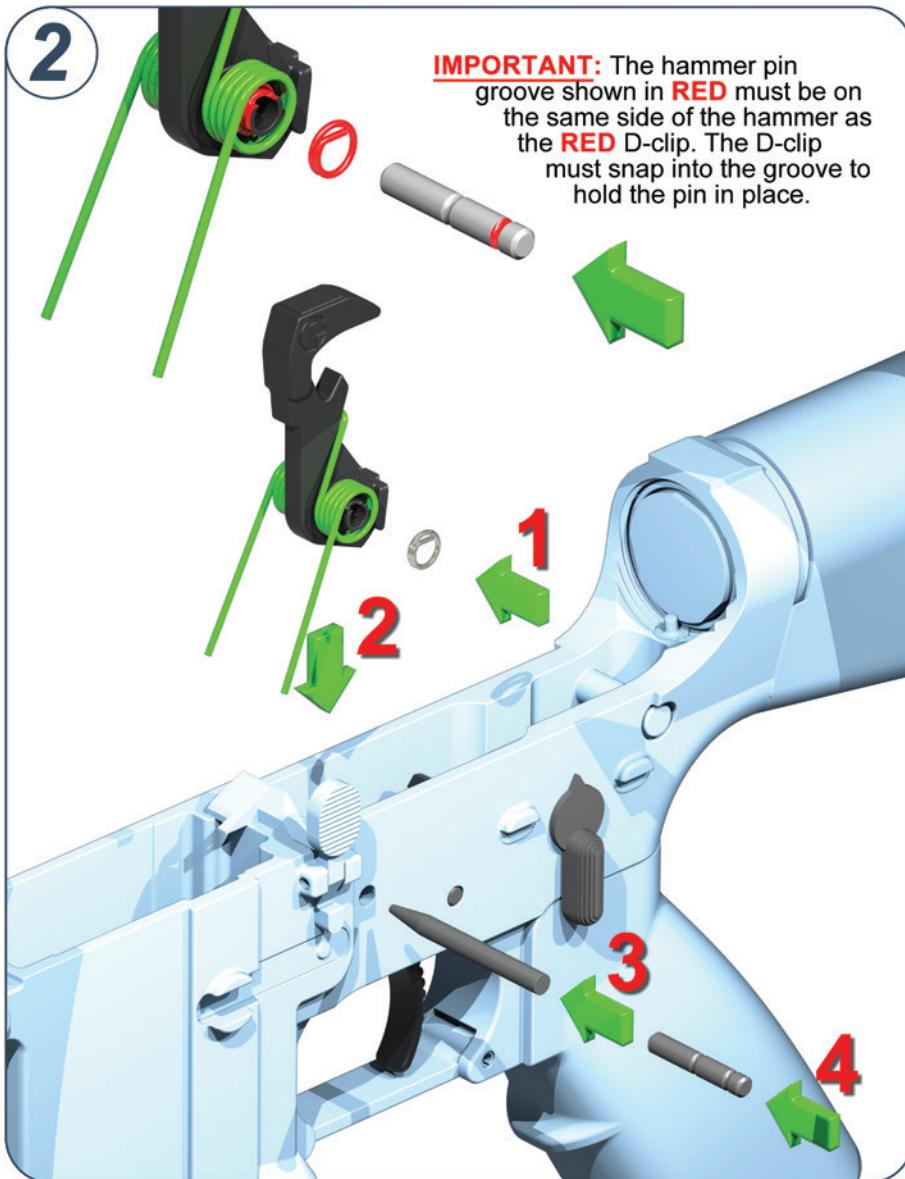

Install the hammer spring onto the hammer as shown. Snap the D-clip onto the hammer with the straight leg outboard of the hammer and lying in the hammer notch. Install the hammer sub-assembly into the lower receiver just like you would a stock AR hammer, making sure the hammer spring's arms nest in the spaces on either side of the trigger in the lower receiver to retain the trigger pivot pin. Insert the drift pin and follow with the AR pin flush, with its outboard groove on the D-clip side of the hammer .

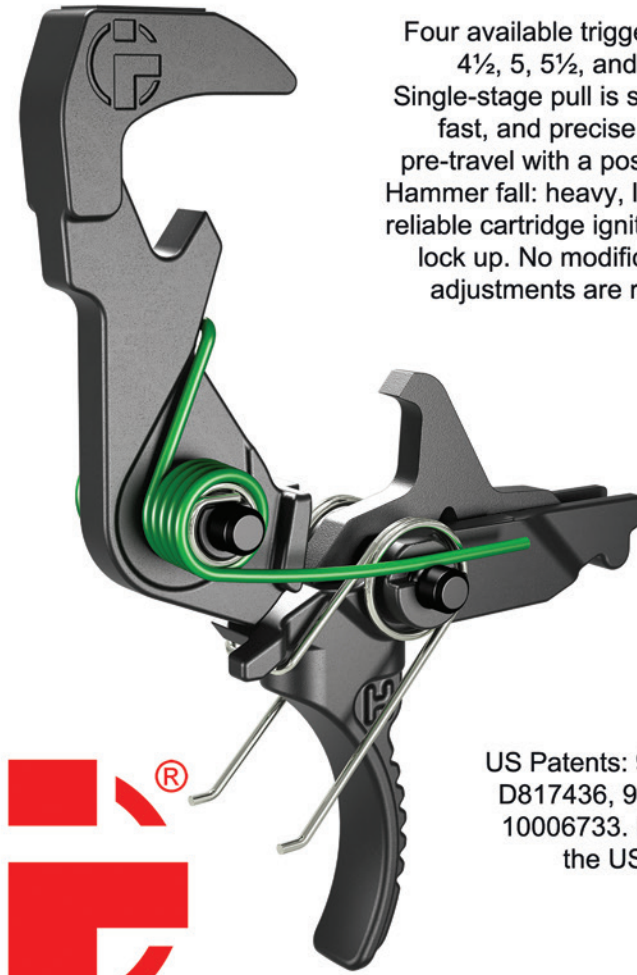

Four available trigger weights:
4½, 5, 5½, and 6 lbs.
Single-stage pull is smooth, flat,
fast, and precise. Hint of
pre-travel with a positive reset.
Hammer fall: heavy, like stock for
reliable cartridge ignition and fast
lock up. No modifications or
adjustments are required.

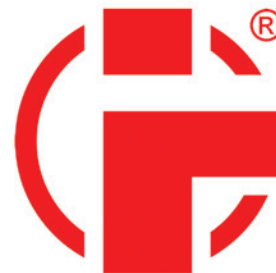

US Patents: 9175917,
D817436, 9696103,
10006733. Made in
the USA.

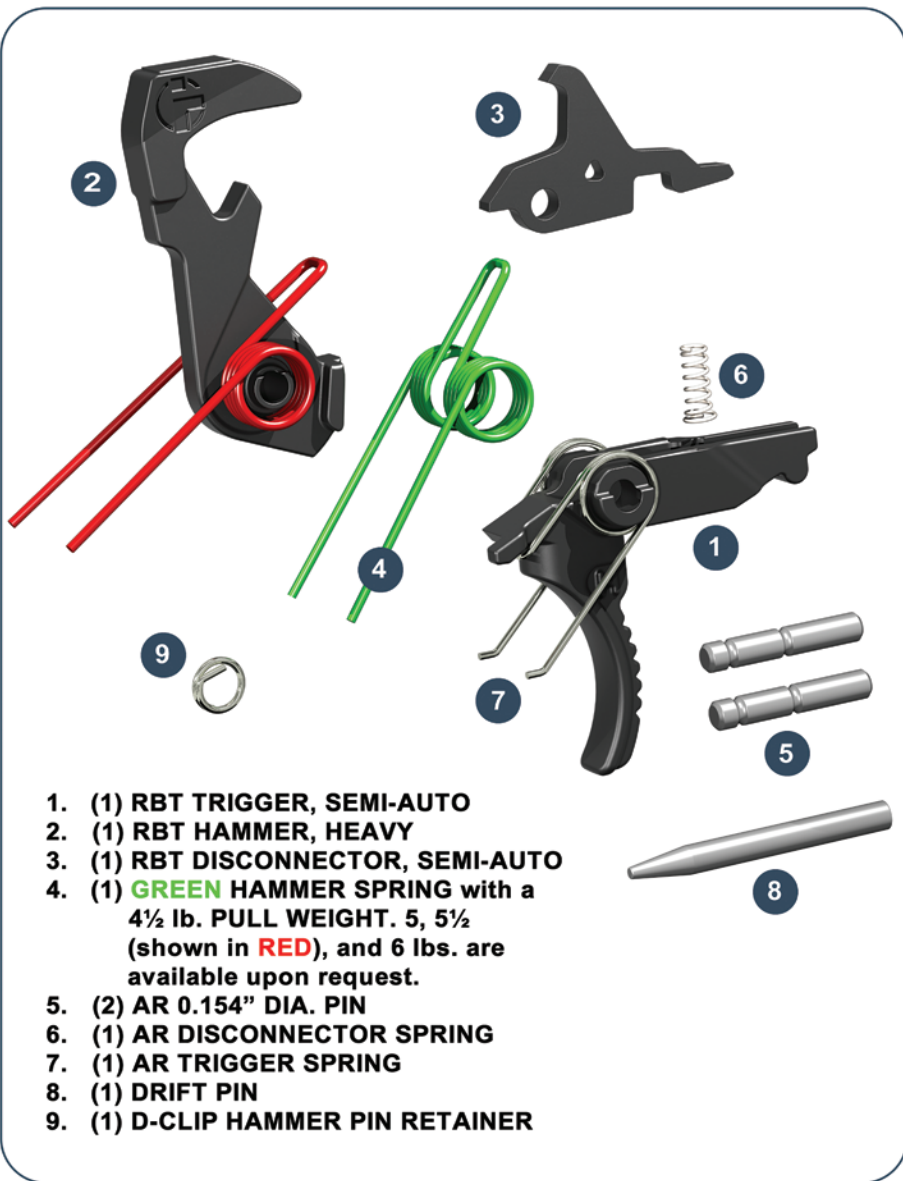

RBT, SEMI-AUTO fire-control group (FCG) parts are shown in the figure by name and required quantity.

IMPORTANT - The correct installation orientation of the hammer spring onto the hammer is shown in the figure. It's possible to install it backwards. Backwards installation would result in a very light trigger pull weight with no-ignition (LPS, light hammer strike).

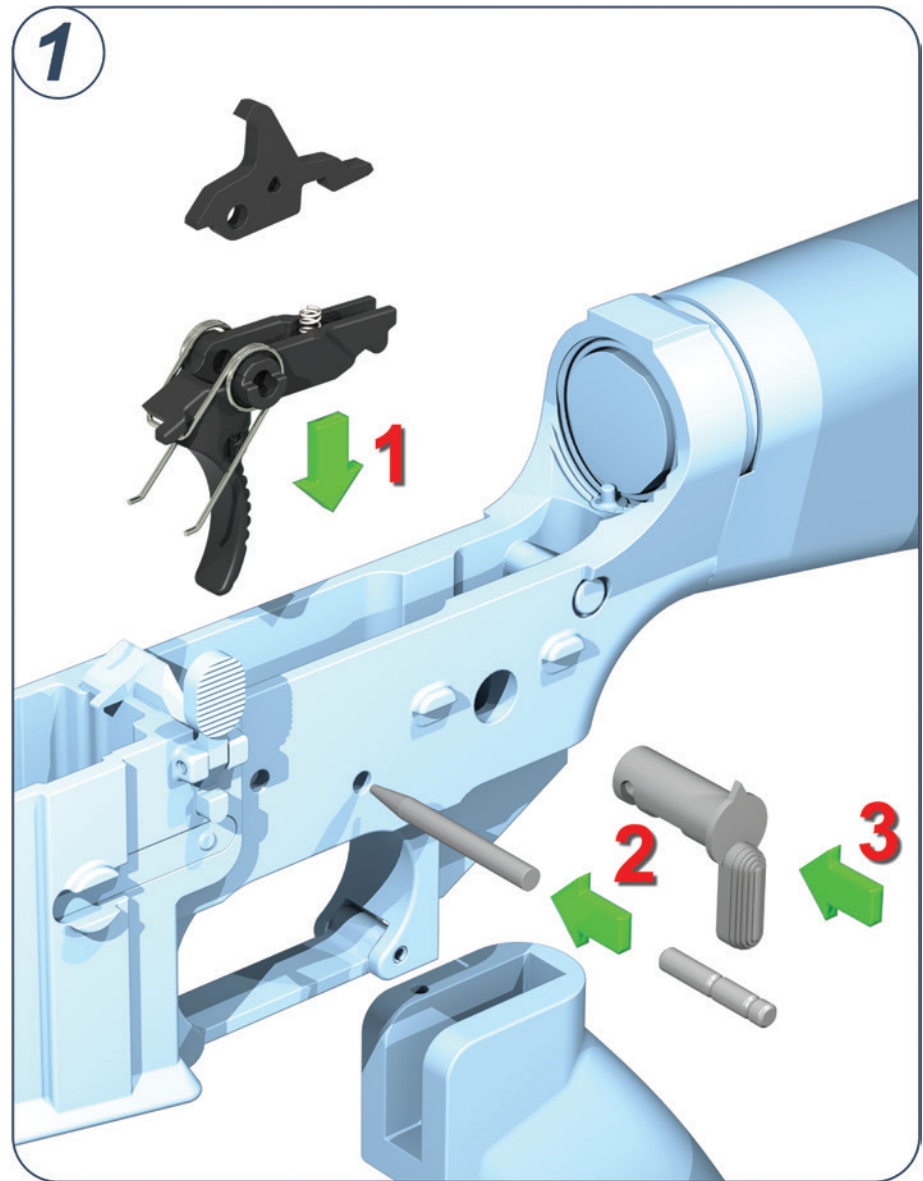

With the safety selector and grip removed, position the trigger subassembly in the lower receiver so the trigger and disconnecter pin holes line up with the receiver's trigger pivot holes. Insert the drift pin into either side of the lower's trigger holes and push it through until the back of the pin is flush with the outside of the receiver. Follow the drift pin with the trigger pin, pushing out the drift pin until the trigger pin is also flush. Reinstall the safety, its detent pin, and spring, then the grip with screw in that order.